

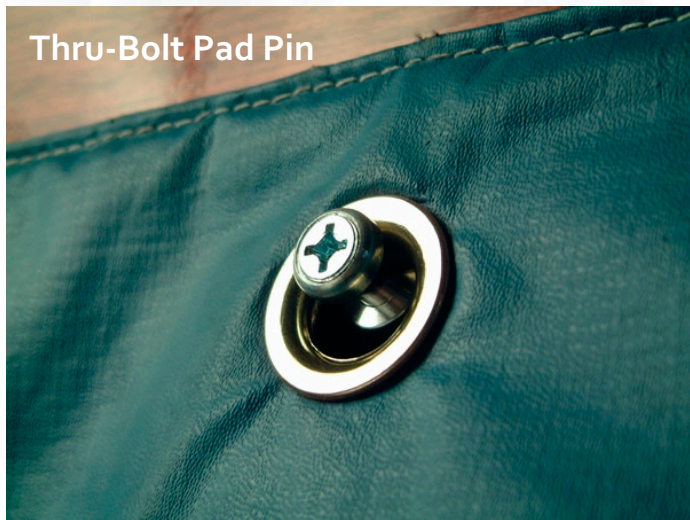

Thru-Bolt Pad Pin



Fixed Stud Pad Pin



Pad Pins available in **THRU-BOLT** or **FIXED STUD** design, with each style offered in four standard lengths. Each Pad Pin is packaged in a quantity of 12, with two easy methods of installation provided:
Thru-Bolt: supplied with threaded bolt (3/16" thread (10-24) & lock nut), as well as wood screw option.
Fixed Stud: supplied with threaded rod (3/16" thread (10-24) & lock nut, as well as threaded wood screw option.
Bulk packaging available (100+).

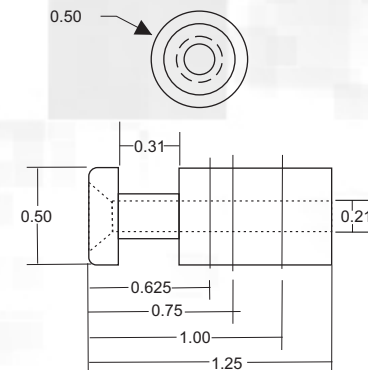

THRU-BOLT PAD PINS

Part #	Description
APT0625A	0.625" Aluminum
APT0625B	0.625" Brass
APT0625S	0.625" Stainless
APT0750A	0.75" Aluminum
APT0750B	0.75" Brass
APT0750S	0.75" Stainless
APT1000A	1.00" Aluminum
APT1000B	1.00" Brass
APT1000S	1.00" Stainless
APT1250A	1.25" Aluminum
APT1250B	1.25" Brass
APT1250S	1.25" Stainless

FIXED STUD PAD PINS

Part #	Description
APF0625A	0.625" Aluminum
APF0625B	0.625" Brass
APF0625S	0.625" Stainless
APF0750A	0.75" Aluminum
APF0750B	0.75" Brass
APF0750S	0.75" Stainless
APF1000A	1.00" Aluminum
APF1000B	1.00" Brass
APF1000S	1.00" Stainless
APF1250A	1.25" Aluminum
APF1250B	1.25" Brass
APF1250S	1.25" Stainless

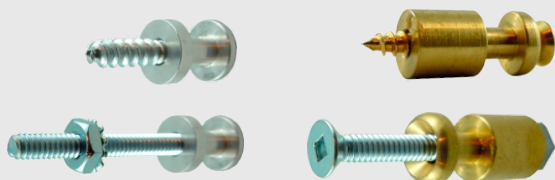

Two Methods of Installation:

1/2" Diameter THRU-BOLT ELEVATOR PAD PINS and FIXED STUD ELEVATOR PAD PINS are designed to accept a standard 10-24 tapered wood screw or machine bolt, both are included.